

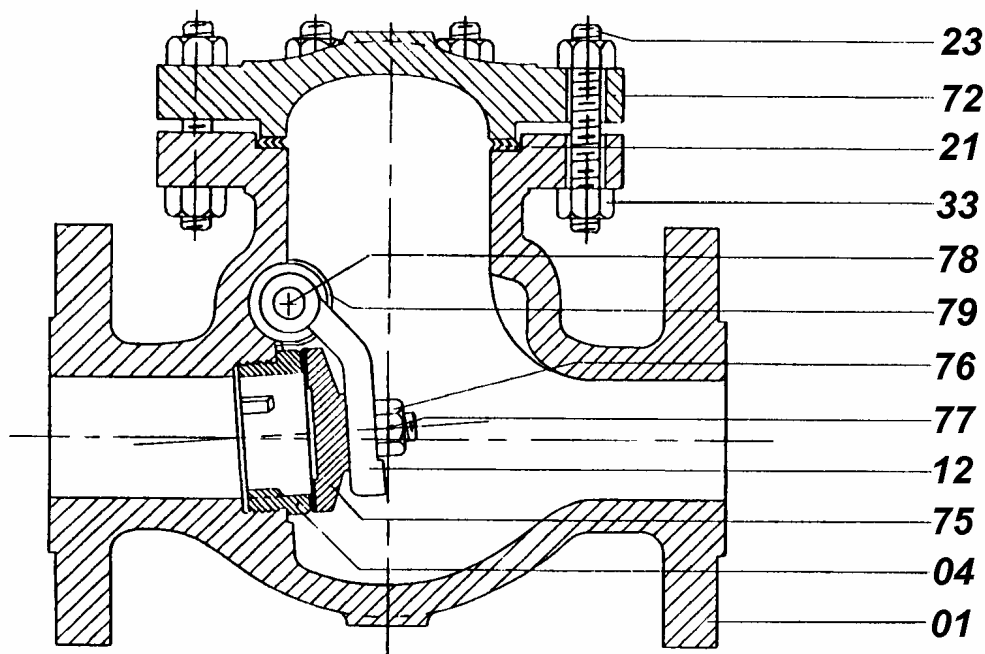

**Válvula de RETENCION tipo CHARNELA. SWING CHECK valve. ASTM A216
Gr.WCB. Trim API 600 # 1.**



<i>It.</i>	<i>Descripción</i>	<i>Material</i>	<i>It.</i>	<i>Description</i>
01	Cuerpo	ASTM A 216 Gr.WCB	01	Body
04	Asiento	ASTM A 216 Gr.WCB + 13%Cr.	04	Seat ring
12	Palanca	ASTM A 216 Gr.WCB	12	Hinge or disc carrier
21	Junta	Graphite	21	Gasket
23	Espárrago cuerpo-bonete	ASTM A 193 Gr.B7	23	Body-bonnet stub
33	Tuerca cuerpo-bonete	ASTM A 194 Gr.2H	33	Body-bonnet nut
72	Bonete	ASTM A 216 Gr.WCB	72	Bonnet
75	Disco	ASTM A 216 Gr.WCB + 13%Cr.	75	Disc
76	Tuerca bloqueo disco	ASTM A276 Gr.316	76	Disc lock-nut
77	Espina de bloqueo	ASTM A276 Gr.316	77	Pin
78	Eje	ASTM A276 Gr.410	78	Axis
79	Tapón bloqueo eje	ASTM A 105	79	Bumper plug



Válvula de RETENCION tipo CHARNELA. SWING CHECK valve. ASTM A216 Gr.WCB. Trim API 600 # 1.

Válvula de RETENCION TIPO CHARNELA, acero carbono, fundido, ASTM A216 Gr.WCB, extremos bridados. Bonete abulonado, Asiento renovable. Montaje API 600 # 1,
 SWING CHECK valve, cast carbon steel, ASTM A216 Gr.WCB, flanged ends. Bolted bonnet, Renewable seat ring.
 Trim API 600 # 1.

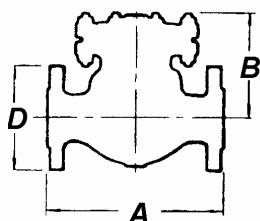

RF

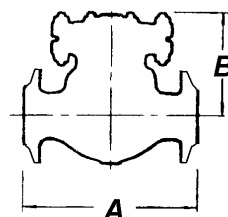

BW

CLASS 150 - SERIE 150

ANSI serie 150(extremos RF) Class 150 {RF ends}						
Medida Nominal		RF	BW	Altura	Diámetro	Peso
Nominal size		A	A1	Height	Diameter	Weight RF
Inch	mm	A	A1	B	D	kg.
1"	25	127,0	127,0	110,0	107,9	5,0
1 ½"	40	165,1	165,1	130,0	127,0	9,5
2"	50	203,2	203,2	145,0	152,4	15,0
2 ½"	65	215,9	215,9	170,0	177,8	17,0
3"	80	241,3	241,3	180,0	190,5	21,0
4"	100	292,1	292,1	205,0	228,6	34,0
5"	125	330,2	330,2	223,0	254,0	61,5
6"	150	355,6	355,6	260,0	279,4	66,0
8"	200	495,3	495,3	310,0	342,9	143,0
10"	250	622,3	622,3	350,0	406,4	226,0
12"	300	698,5	698,5	390,0	482,6	271,0
14"	350	787,4	787,4	435,0	533,4	395,0
16"	400	863,6	863,6	480,0	596,9	495,0
18"	450	977,9	977,9	540,0	635,0	583,0
20"	500	977,9	977,9	600,0	698,5	835,0
24"	600	1295,4	1295,4	645,0	812,8	1030,0



**Válvula de RETENCION tipo CHARNELA. SWING CHECK valve. ASTM A216
Gr. WCB. Trim API 600 # 1.**

CLASS 300 - SERIE 300

ANSI serie 300(extremos RF) Class 300 {RF ends}						
Medida Nominal		RF	BW	Altura	Diámetro	Peso
Nominal size				Height	Diameter	Weight RF
Inch	mm	A	A	B	D	kg.
1"	25	215,9	215,9	120,0	123,9	12,0
1 1/2"	40	241,3	241,3	142,0	155,4	16,0
2"	50	266,7	266,7	165,0	165,1	25,0
2 1/2"	65	292,1	292,1	175,0	190,5	36,0
3"	80	317,5	317,5	200,0	209,5	38,0
4"	100	355,6	355,6	230,0	254,0	63,0
5"	125	400,0	400,0	270,0	279,4	92,0
6"	150	444,5	444,5	280,0	317,5	130,0
8"	200	533,4	533,4	336,0	381,0	201,0
10"	250	622,3	622,3	375,0	444,5	310,0
12"	300	711,2	711,2	420,0	520,7	450,0
14"	350	838,2	838,2	480,0	584,2	620,0
16"	400	863,6	863,6	520,0	647,7	774,0
18"	450	977,9	977,9	590,0	711,2	1116,0
20"	500	1016,0	1016,0	670,0	774,7	1273,0
24"	600	1346,2	1346,2	750,0	914,4	1650,0

CLASS 600 - SERIE 600

ANSI serie 600(extremos RF) Class 600 {RF ends}						
Medida Nominal		RF	BW	Altura	Diámetro	Peso
Nominal size				Height	Diameter	Weight RF
Inch	mm	A	A	B	D	kg.
1"	25	215,9	215,9	132,0	123,9	14,5
1 1/2"	40	241,3	241,3	160,0	155,4	19,0
2"	50	292,1	292,1	175,0	165,1	34,0
2 1/2"	65	330,2	330,2	195,0	190,5	38,0
3"	80	355,6	355,6	235,0	209,5	62,0
4"	100	431,8	431,8	208,0	273,0	110,0
6"	150	558,0	558,0	365,0	355,6	224,0
8"	200	660,4	660,4	410,0	419,1	388,0
10"	250	787,4	787,4	480,0	508,0	528,0
12"	300	838,2	838,2	520,0	558,8	695,0
14"	350	889,0	889,0	560,0	603,2	892,0
16"	400	990,6	990,6	650,0	685,8	1200,0
18"	450	1092,2	1092,2	730,0	742,9	1600,0
20"	500	1193,8	1193,8	800,0	812,8	2420,0
24"	600	1397,0	1397,0	900,0	939,8	3150,0



**Válvula de RETENCION tipo CHARNELA. SWING CHECK valve. ASTM A216
 Gr. WCB. Trim API 600 # 1.**

CLASS 900 - SERIE 900

ANSI serie 900(extremos RF) Class 900 {RF ends}						
Medida Nominal		RF	BW	Altura	Diámetro	Peso
Nominal size				Height	Diameter	Weight RF
Inch	mm	A	A1	B	D	kg.
3"	80	381.0	381.0	295.0	241.3	100.0
4"	100	457.2	457.2	300.0	292.1	165.0
6"	150	609.6	609.6	380.0	381.0	310.0
8"	200	736.6	736.6	440.0	469.9	500.0
10"	250	838.2	838.2	480.0	546.1	772.0
12"	300	965.2	965.2	560.0	609.6	1080.0
14"	350	1028.7	1028.7	630.0	641.3	1380.0
16"	400	1130.3	1130.3	700.0	704.8	1810.0
18"	450	1219.2	1219.2	750.0	787.4	2400.0
20"	500	1320.8	1320.8	850.0	857.2	3500.0
24"	600	1549.4	1549.4	1000.0	1041.4	4700.0

NOTAS:
 Medida nominal hasta 2 1/2" inclusive, se utilizan las dimensiones de la serie 1500.
 Nominal size up to 2 1/2" use class 1500 dimensions.

CLASS 1500 - SERIE 1500

ANSI serie 1500(extremos RF) Class 1500 {RF ends}						
Medida Nominal		RF	BW	Altura	Diámetro	Peso
Nominal size				Height	Diameter	Weight RF
Inch	mm	A	A	B	D	kg.
2"	50	368.0	368.0	250.0	215.9	86.0
2 1/2"	65	419.1	419.1	280.0	244.3	116.0
3"	80	469.9	469.9	295.0	266.7	124.0
4"	100	546.1	546.1	385.0	311.1	231.0
6"	150	704.8	704.8	500.0	393.7	585.0
8"	200	831.8	831.8	510.0	482.6	945.0
10"	250	990.6	990.6	560.0	584.2	1275.0
12"	300	1130.0	1130.0	650.0	673.1	1870.0
14"	350	1257.3	1257.3	750.0	749.3	2560.0
16"	400	1384.8	1384.8	800.0	825.5	3260.0



Válvula de RETENCION tipo CHARNELA. SWING CHECK valve. ASTM A216 Gr.WCB. Trim API 600 # 1.

Válvula de RETENCION TIPO CHARNELA, acero carbono, fundido, ASTM A216 Gr.WCB, extremos bridados. Bonete abulonado, Asiento renovable. Montaje API 600 # 1,
SWING CHECK valve, cast carbon steel, ASTM A216 Gr.WCB, flanged ends. Bolted bonnet, Renewable seat ring.
Trim API 600 # 1.

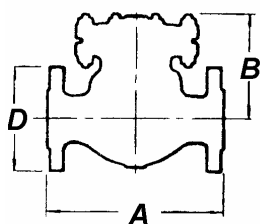

RF

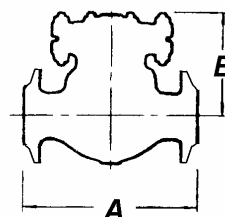

BW

CLASS 2500 - SERIE 2500

Medida Nominal		RF	BW	Altura	Diámetro	Peso
Nominal size				Height	Diameter	Weight RF
Inch	mm	A	A	B	D	kg.
2"	50	450,8	450,8	280,0	235,0	113,0
2 1/2"	65	508,0	508,0	304,0	266,7	163,0
3"	80	577,8	577,8	330,0	304,8	249,0
4"	100	673,1	673,1	356,0	355,6	354,0
6"	150	914,4	914,4	460,0	482,6	908,0
8"	200	1022,3	1022,3	530,0	552,5	1630,0
10"	250	1270,0	1270,0	585,0	673,1	2360,0
12"	300	1422,4	1422,4	685,0	762,0	3400,0